

**LEGEND**

-  GRASS
-  CONCRETE
-  ASPHALT PAVEMENT
-  TREES
-  INLET

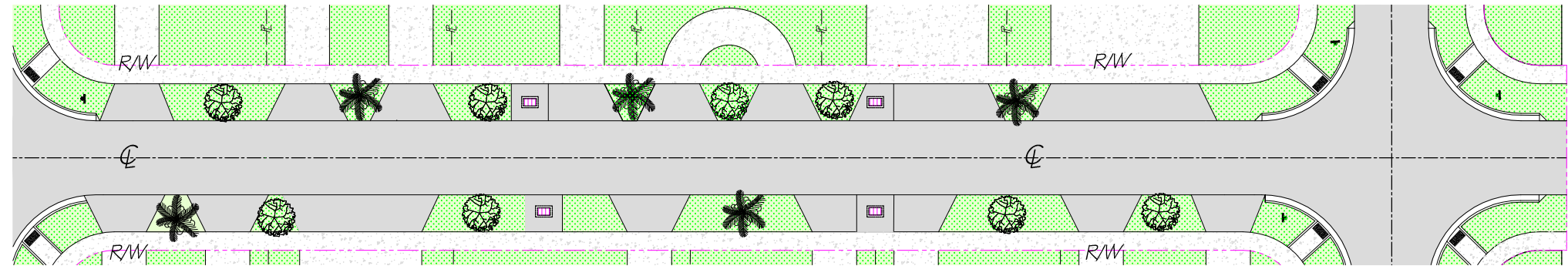

**DEPARTMENT OF RESILIENCE AND PUBLIC WORKS  
BULLETIN NO. 28**

**Subject: PAVING RIGHT-OF-WAY DRAINAGE SWALES**

Issue Date: July 20, 2023 (Rev.)

Prepared by: Jose J. Borrego, P.E., C.G.C., Professional Engineer II

APPROVED:   
Juvenal Santana, Jr., P.E., C.F.M., Director

The purpose of this bulletin is to identify the amount of the right-of-way drainage swale that may be paved by the abutting private property owner. **The following options apply only to those roadways without curbs and/or gutters.**

1. The width of standard driveway approach shall match the width and location of the improved surface driveway on private property. Driveway approach shall be constructed according to City of Miami, Department of Resilience and Public Works (RPW) Engineering Standards for Design and Construction, Indexes R-15, R-16, and R-53.
2. In the event that the width of the private driveway is less than sixty-six (66) percent of the total linear footage width of the abutting owner's private property, the property owner may, subject to approval of the RPW Director, or his/her designee, and upon issuance of a RPW Driveway Approach construction permit, pave the right-of-way drainage swale between the edge of road pavement and face of sidewalk, or base building line (BBL) where sidewalk does not exist, up to a maximum of sixty-six (66) percent of the total linear footage width of the abutting owner's private property. The driveway approach shall be included in the sixty-six (66) percent calculation. Said paving shall be in accordance with City of Miami, RPW Engineering Standards for Design and Construction, Indexes R-15, R-16, and R-53. The remaining right-of-way drainage swale shall be graded and sodded to provide roadway drainage.
3. Proposed paving of the drainage swale area with impervious material in an amount greater than sixty-six (66) percent of the total linear footage width of the abutting owner's private property is prohibited.
4. The installation of markings, fencing, gravels, rocks, or other devices to delineate or restrict the use of the paved area shall be prohibited. The property owner shall be responsible for any improvements or modifications that the RPW Director or his/her designee may require as a condition of approval.

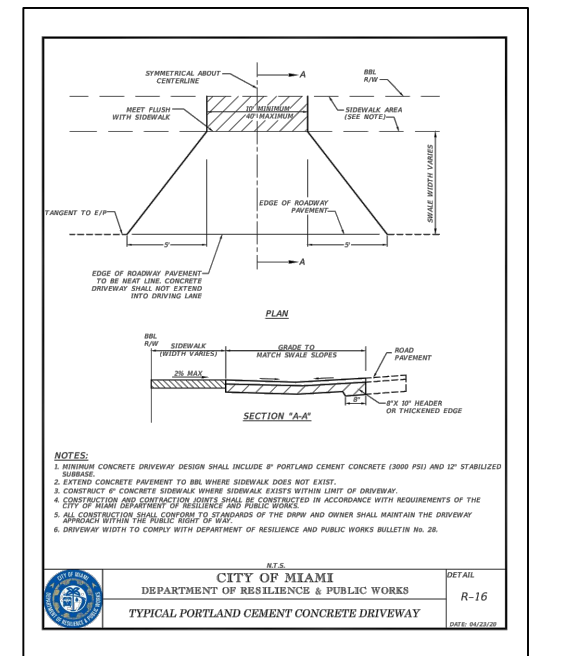
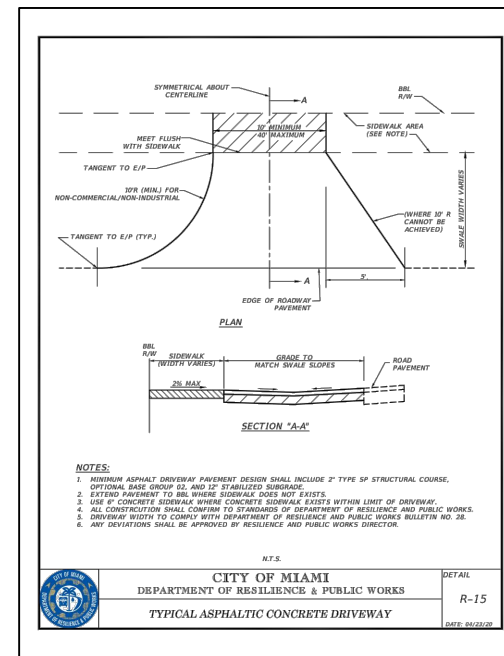
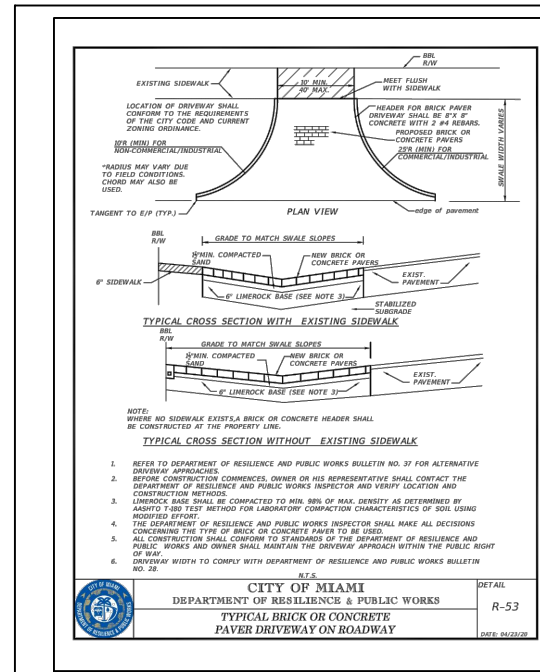
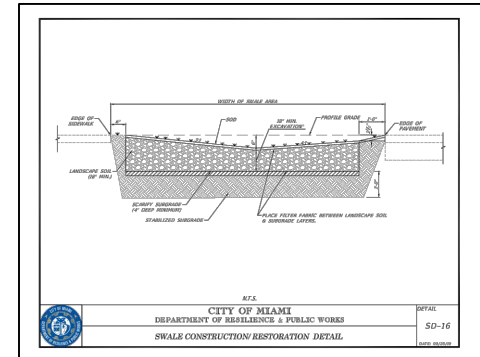

**EAST FLAGAMI FLOOD  
IMPROVEMENTS  
PROJECT**



**PAVING RIGHT-OF-WAY DRAINAGE SWALES**



**CITY COMMISSION  
DISTRICT 4**